

SINTERLEGHIE

Your needs. Our quality.

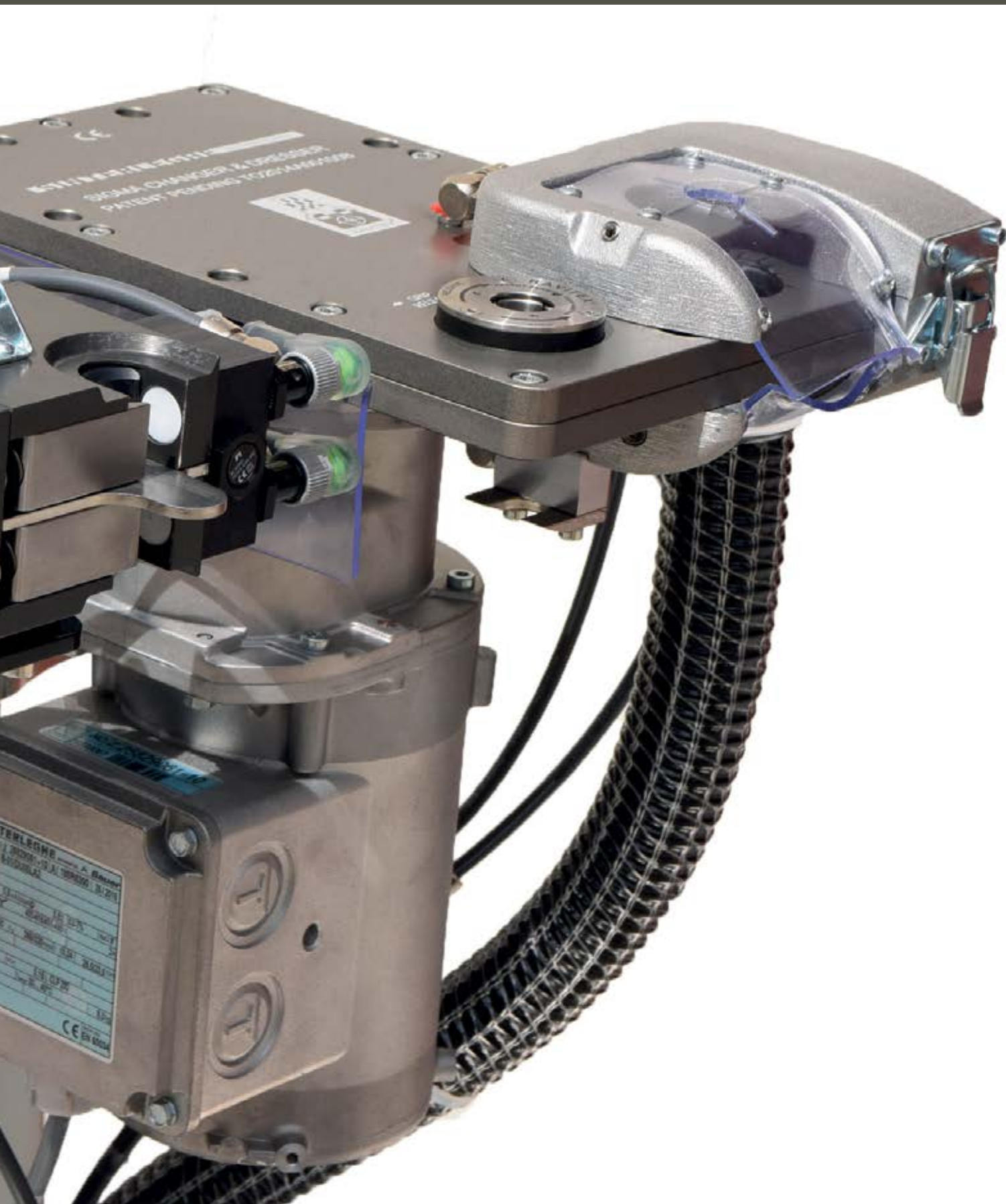

WHO WE ARE

SINTERLEGHE is world leader in the **design**, **manufacture** and **sale** of **tip dressers**, **electrode tip changers** and **metal cutters** for resistance welding electrodes, **supplying** major car manufacturers.

SINTERLEGHE is specialized in the design and manufacturing of tip dressers, electrode tip changers and metal cutters for spot welding electrode tip dressing.

Established in 1989 by **Eugenio Tedeschi**, the company developed its know-how, which allowed it to grow and differentiate its offer by reaching **high qualitative standards**.

The tenacity and perseverance in accomplishing its goals allowed **SINTERLEGHE** to devise new **design solutions** that ultimately became **patents**. This is an added value to a company that made innovation and technology

evolution its strength. Today **SINTERLEGHE** is a key partner for large international groups involved in car manufacturing.

Since 1992 its products, made in the facility of Anzola d'Ossola (VB), have been known all over the world with the brand **Ravitex**[®], sold in 4 continents and 23 Countries.

With offices in Marburg, Germany, and Sao Paulo, Brazil, and its **partnership** networks (including an agreement with Shanghai Faith Co., Ltd. for the Chinese market), **SINTERLEGHE** controls and supplies the European, Asian, US and South American markets.



OUR CUSTOMERS



北汽集团
BAIC Group



FIAT CHRYSLER AUTOMOBILES



IVECO



TOWER
INTERNATIONAL



OUR PRODUCTS
ARE INSTALLED IN
4 CONTINENTS AND 23 COUNTRIES

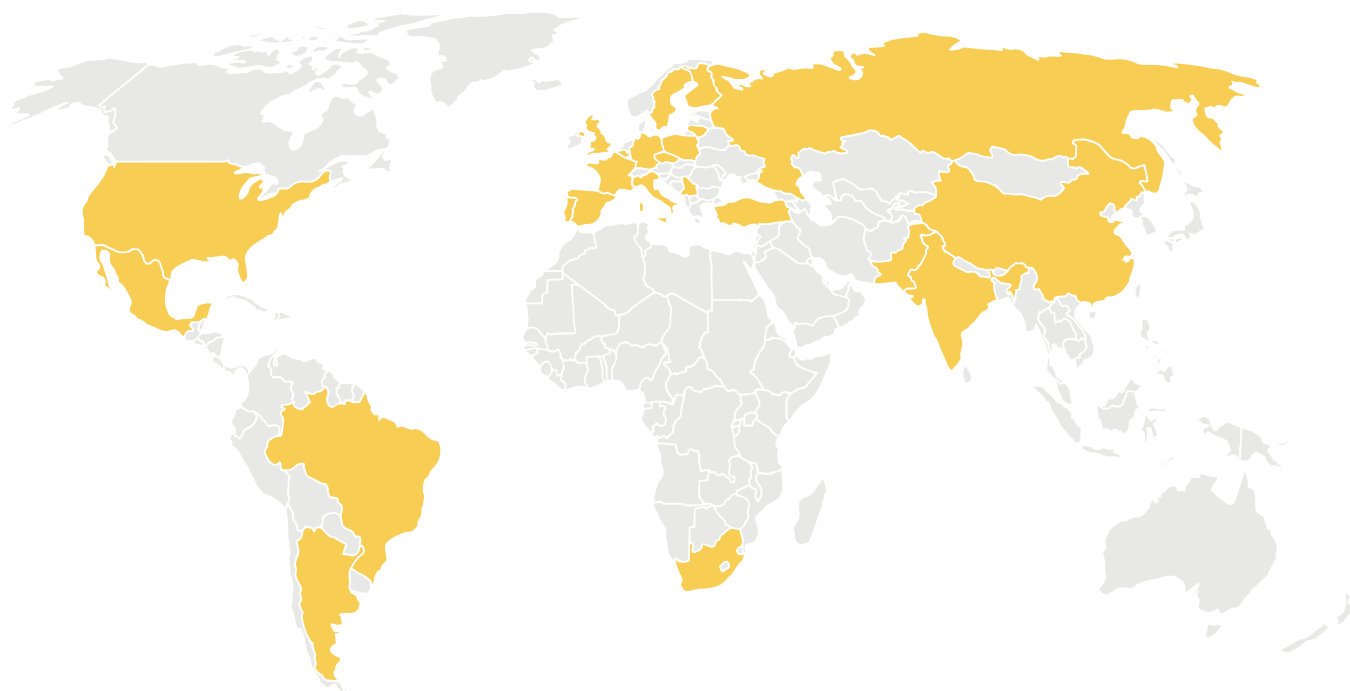

OUR QUALITY

SINTERLEGHE has developed business and organisational strategies targeted at improving the *quality, competitiveness* and *productivity of the company* by leveraging processes and the relentless growth of key skills.

SINTERLEGHE operates in view of product and process improvement according to the standard ISO EN 9001-2008. In 1998 the company introduced a quality management system for its internal processes in compliance with the certified and internationally recognised model.

Quality and development goals are pursued not only through the steady review of products and production processes, but also through the professional development of company resources. In 2016 SINTERLEGHE started a training programme with FESTO Consulting, a major international consultancy firm,

for the development of individual skills prescribed at different organisational levels.

The application of working methods and standards targeted at Total Quality Management, together with the adoption of a new management model based on processes, are targeted at obtaining better performance in terms of productivity, flexibility, responsiveness and reliability.

The higher empowerment and the active involvement of staff in company decisions through targeted actions and plans are a strategic element to accomplish growth and development targets.

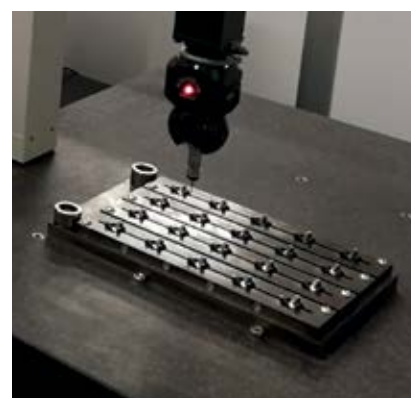
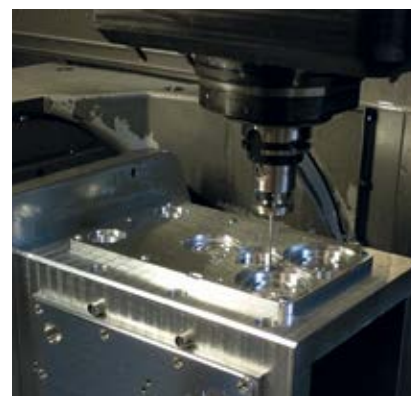

WHY SINTERLEGHE

SINTERLEGHE puts its **expertise**, **ability** and **professionalism** at the service of its clients. The goal is meeting the most advanced needs in the tip dressing and electrode tip exchange segments by developing a **business process of re-engineering** and **redesign** going through **technology innovation** and steady product and process development.



Technology innovation

SINTERLEGHE's design ideas have turned into patents, as an important guarantee for consumers, certifying the **originality** and **quality** of Ravitex® know-how.



Expertise and know-how

The collaboration with major automotive players worldwide allowed SINTERLEGHE to develop a strong **know-how** and an **in-depth knowledge** of the target market.



Superior quality

Ravitex® products meet the needs of the most advanced production lines, accomplishing ambitious goals in terms of process cost reduction, production capacity increase, quality and environmental friendliness.



Customer care

Ravitex® products result from a careful analysis of clients' needs and requirements. The care for clients prior and after the purchase and their satisfaction are absolute priorities.

RAVITEX® PRODUCTS

The characteristics of Ravitex® products are targeted at the needs of our worldwide clients. Their performance result from intellectual innovation and process quality.



All machining operations are performed in the Anzola d'Ossola (VB) plant with high-output CNC machines. The processes are managed and controlled by a single management software. An air-conditioned metrology room ensures the full dimensional control over the entire manufactured range.

SINTERLEGHE's manufacturing capacity has grown to become more and more flexible over the years thanks to Lean Production and TPS organisational and production methods.

This approach led to optimising internal and outsourcing processes, thereby reducing lead times.

SIGMA POWER SPECIFICATION

The table below shows the details of electrical and pneumatic connections available.

SPECIFICATIONS	EEC SOUTH AMERICA AFRICA - INDIA	CHINA	USA
POWER	0,8 kW	0,8 kW	0,8 kW
FREQUENCY	50/60	50	50/60
SUPPLY	Y 380- 420 V 50 Hz 2A	400 VAC 50 Hz 2A	Y 380- 420 V 60 Hz 2A
SUPPLY	Y 380- 480 V 60 Hz 2A		Y 380- 480 V 60 Hz 2A
SUPPLY OPTIONAL			Δ 230-300 V 60 Hz 3.46A
SUPPLY OPTIONAL			Δ 220-255 V 50 Hz 3.46A
DUTY TYPE	S3-7%	S1	S3-7%
CERTIFICATION	CE	CCC	AM-UL
INTAKE SUCTION DEVICE	450 l/min @ 6 bar	450 l/min @ 6 bar	450 l/min @ 6 bar
INTERNAL Ø AIR SUPPLY PNEUMATIC PIPE	Ø 6,00 mm	Ø 6,00 mm	Ø 6,00 mm
COMPRESSED AIR SUPPLY	5÷8 bar - ISO 8573 Class 3.4.3	5÷8 bar - ISO 8573 Class 3.4.3	5÷8 bar - ISO 8573 Class 3.4.3
DEGREE OF PROTECTION IP	54	54	54
TUBES AND FITTINGS	ISO	ISO	ISO
SOLENOID VALVES	ISO	ISO	ISO



INDEX OF MACHINES & ACCESSORIES

Dresser SIGMA Electric
for Robot Welding Guns 10 - 11

SIGMA Changer & Dresser
Patent **1427232** 12 - 13

SIGMA Swivelling Unit 14 - 16

SIGMA Pneumatic Changer
Patent **1427232** 17

SIGMA Manual Dresser 18

OMICRON Optical Sensor
Patent **EP2938454** 19

Accessories 20 - 21

Dresser SIGMA Electric for Robot Welding Guns

Description

- 01 Machines
- 01 Tip dresser
- 01 SIGMA series electric motor
- XXXXX Sequential edited by the SINTERLEGHE Technical office for client's technical specifications

MECHANICAL INTERFACE

	<ul style="list-style-type: none"> • (LxW) 300 x 300 mm
Base Plate	<ul style="list-style-type: none"> • (Ground fixing holes) 4 x Ø 26 mm holes • (Distance between holes) 230 x 230 mm
Tip dresser's head	• 2 x M10 screws distance between holes 60 mm
Head orientation	• Dressing head adjustable in 2 positions

TIP DRESSER'S FEATURES

Distance cutter center - carter edge	39 mm
Tip-dresser's head height	20 mm
Cutter rotation speed loadless	210 rpm
Cutter rotating direction	Clockwise
Tip-dresser's head equalization height	+/- 30 mm

Electric and pneumatic connection: check availability on pag. 7

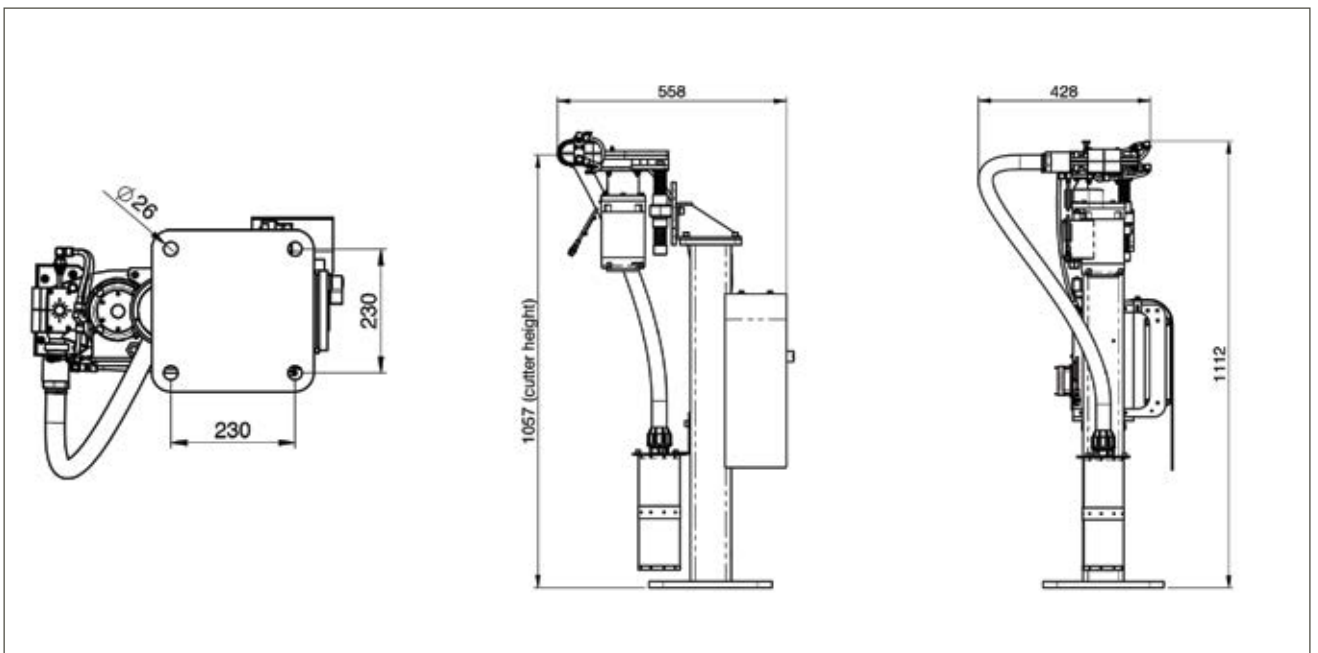



Better performance with a powerful pneumatic suction device.

Carter is fixed only on upside to allow the fast disassembly for easy maintenance.

Most reliability due to new gears design and to new hardness and surfaces treatments to avoid corrosion.

High cutting torque: power motor up to 0,8kW.

Equalization system:
- Up to ± 30 mm range.
- Very smooth movements.

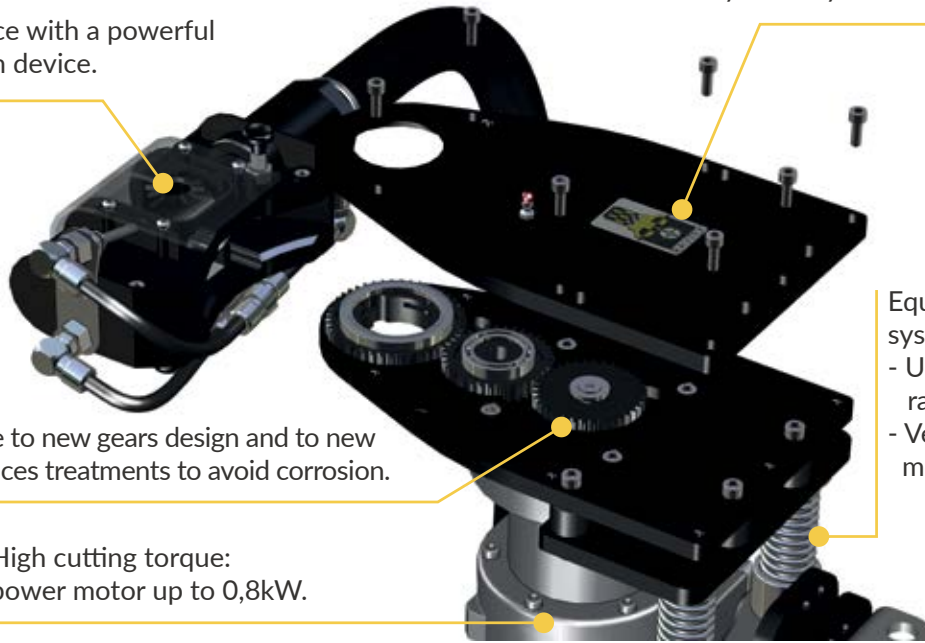

TIP DRESSER VERSION H

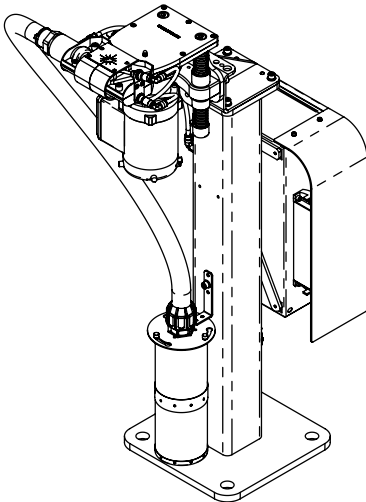

TIP DRESSER VERSION V1

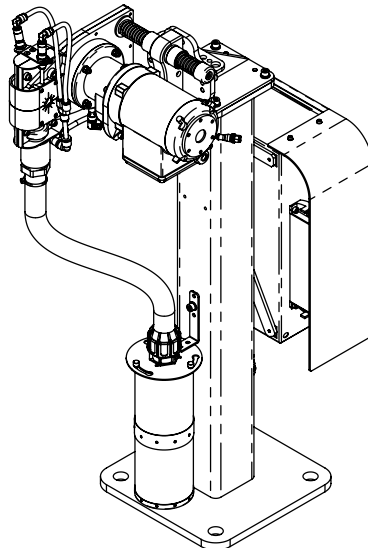

TIP DRESSER VERSION V2

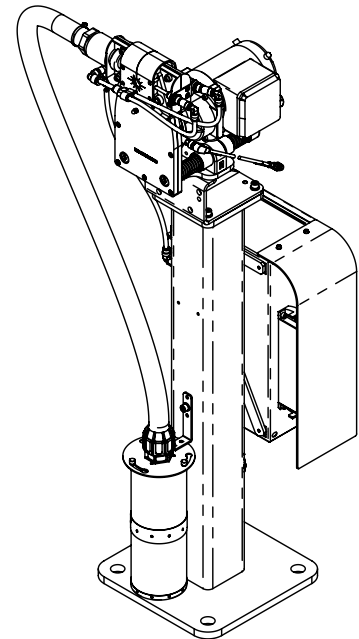

It's possible to configure SIGMA electric dresser in H - V1 - V2 position without any additional optionals.

SIGMA Changer & Dresser

Patent 1427232

Description

- 01 Machines
- 06 Tip dresser + electrode changer
- 01 SIGMA series electric motor
- xxxxx Sequential edited by the SINTERLEGHE Technical office for client's technical specifications

MECHANICAL INTERFACE

	<ul style="list-style-type: none"> • (LxW) 300 x 300 mm
Base Plate	<ul style="list-style-type: none"> • (Ground fixing holes) 4 x Ø 26 mm holes • (Distance between holes) 230 x 230 mm
Tip dresser's head	• 2 x M10 screws distance between holes 60 mm
Head orientation	• Dressing head adjustable in 2 positions

TIP DRESSER'S FEATURES

Distance cutter center - carter edge	39 mm
Tip-dresser's head height	20 mm
Cutter rotation speed loadless	210 rpm
Cutter rotating direction	Clockwise
Tip-dresser's head equalization height	+/- 30 mm
Bidirectional releasing system Patent 1427232	

Electric and pneumatic connection: check availability on pag. 7

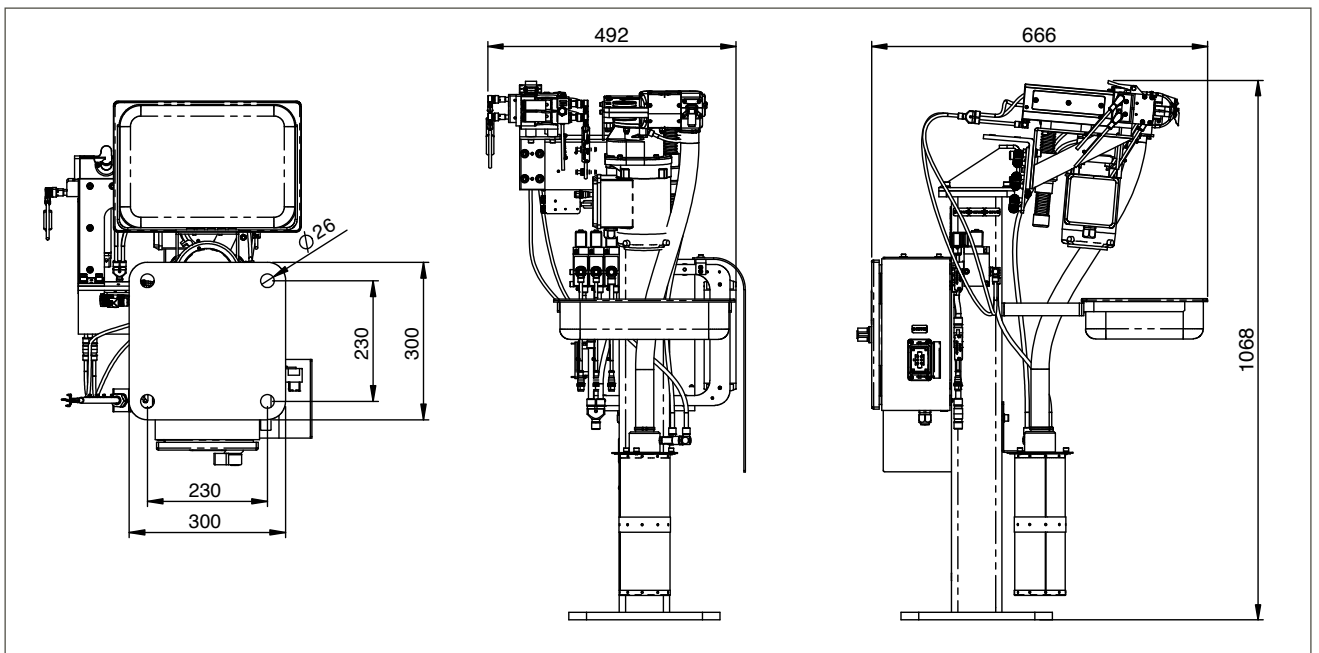

Electrodes Magazine Patent 1420033

Total pneumatic movements controlled by robot. Self cleaning feature for each loading by air jet.

Up to 14+14 electrodes $\varnothing 16$ or 10+10 electrodes $\varnothing 20$ stored and protected until the loading.

2 sensors to alert the reloading of the magazine.

Possible to load different types of electrodes upside and lowerside.

Integrated fixing plate (optional).

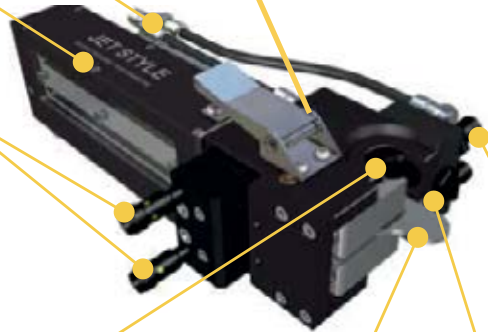

Bidirectionale Releasing System Patent 1427232

- Possibility to release electrode from $\varnothing 13$ to $\varnothing 20$ mm also fixed on screwed holder.
- It's possible to release different type of electrode upper /down side if with the same diameter.
- The release of the electrode is made of 380 millisecond.
- The release upper and down electrode in the same position.
- The force required to release the electrode is auto adaptive from 30 daN at 180 daN at evry cycle.
- To each release operation it takes account of the diameter and the oxidation of electrode.



2 sensors to detect the effective presence of the electrodes in the loading bay before and after the loading on the welding gun.

1 sensor to detect the presence of electrodes on the welding gun before and after the loading of the new electrode.

SIGMA CHANGER & DRESSER POSITION H

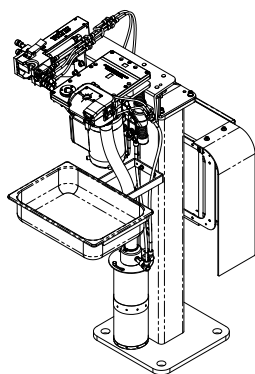

SIGMA CHANGER & DRESSER POSITION V3

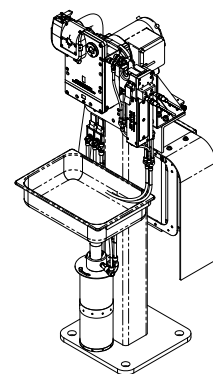

It's possible to configure SIGMA Changer & Dresser in H -V3 position without any additional optionals.

Sigma Swivelling Unit

Description

- Options
- 01 Machines
 - 03 Swivelling Unit
 - 05 Electric Motor without dressing head
 - 01 SIGMA Series electric motor
 - XXXXX Sequential edited by the SINTERLEGHE Technical office for client's technical specifications

MECHANICAL INTERFACE

- | | |
|--------------------|---|
| Base Plate | <ul style="list-style-type: none"> • (LxW) 730 X 180 mm • (Ground fixing holes) 6 x Ø 20 mm holes |
| Tip dresser's head | <ul style="list-style-type: none"> • 2 x M10 screws distance between holes 60 mm |

TIP DRESSER'S FEATURES

Distance cutter center - carter edge	39 mm
Tip-dresser's head height	20 mm
Cutter rotation speed loadless	210 rpm
Cutter rotating direction	Clockwise
Tip-dresser's head equalization height	+/- 30 mm

Electric and pneumatic connection: check availability on pag. 7

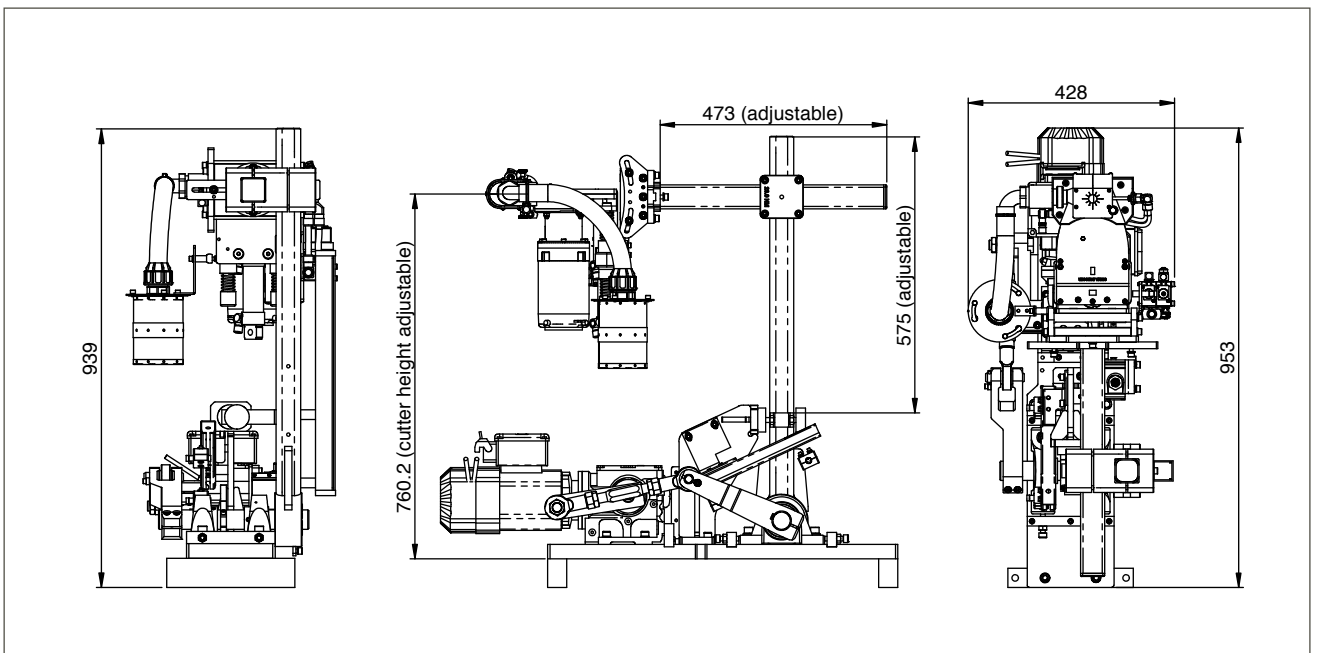



Suction device totally integrated on head.



Head position settings
5 axes fixed 1 axis pneumatic.



Solenoid valves
on head.



Mechanical stop
on dressing position.

Fixed connection
plate.



Transmission
redesigned.

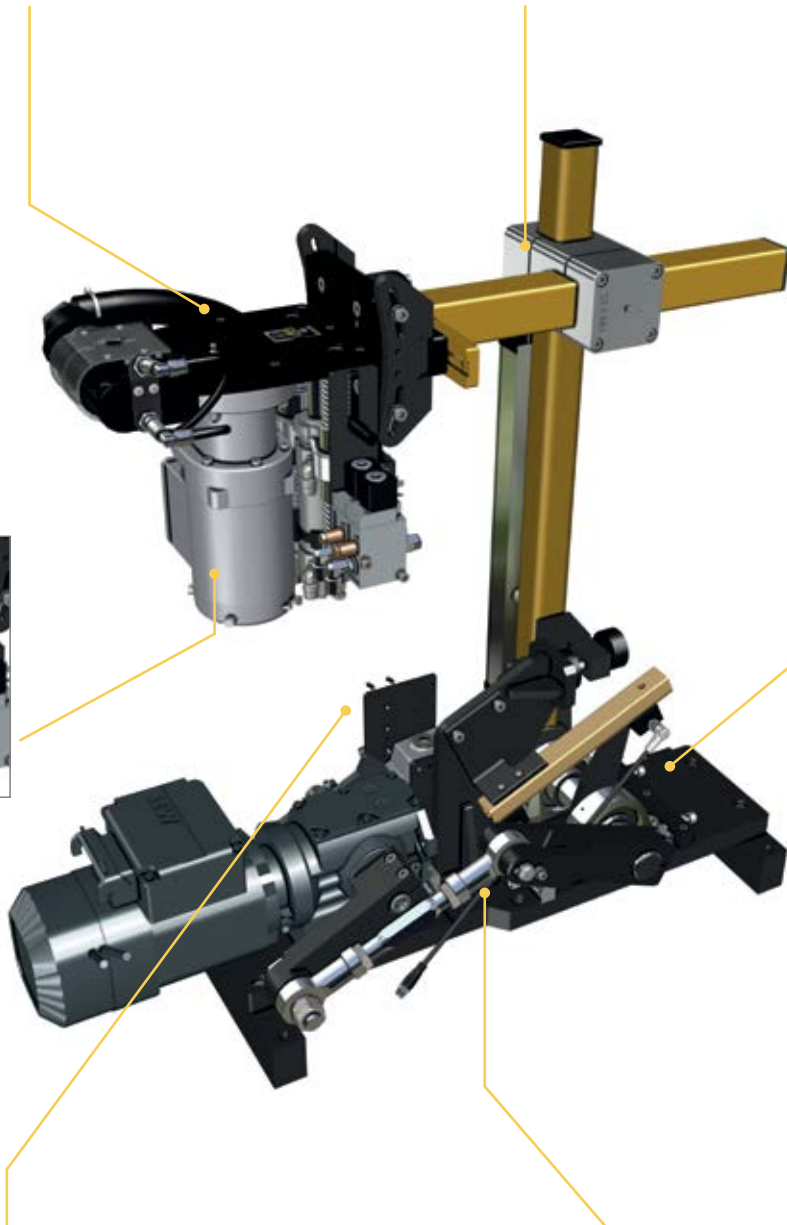

- Collision with the welding gripper impossible thanks to pneumatic head control
- Manual adjustment of the dressing head on 3 axes
- Adjustment of the dressing head positioning arm on 6 axes
- Manual head settings

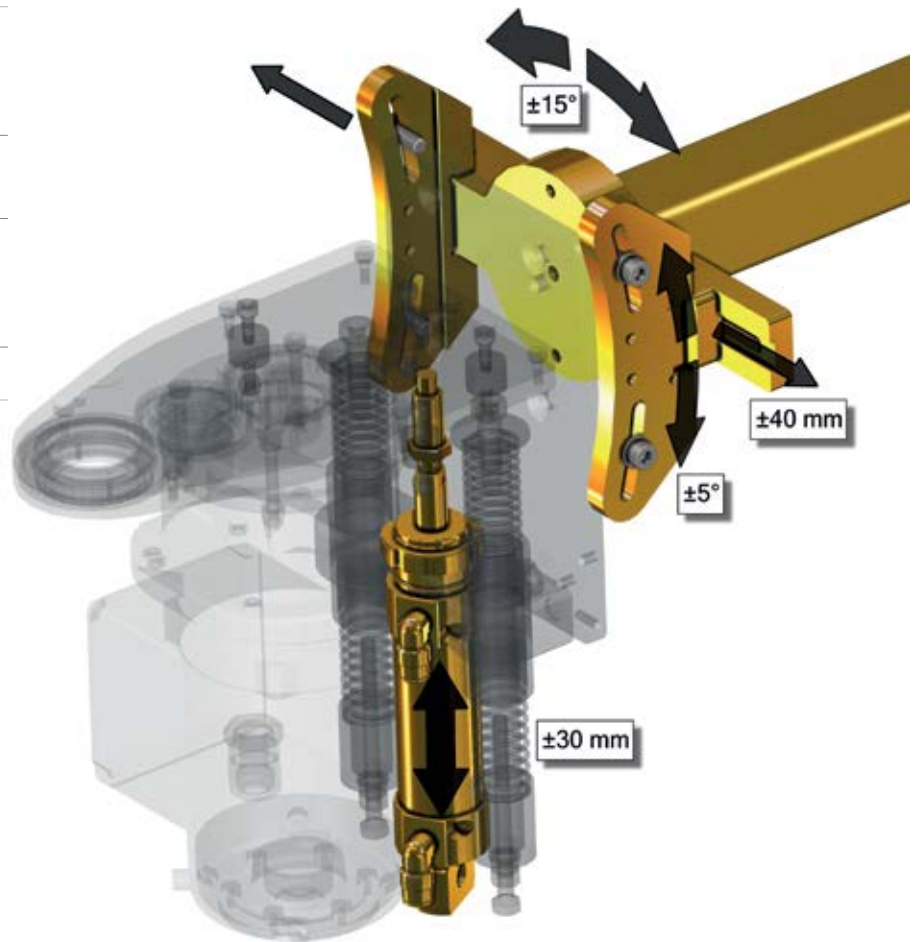

SIGMA SWIVELLING UNIT SETTING 1



SIGMA SWIVELLING UNIT SETTING 3 INCLUDING ADDITIONAL ARM



12 different assembly possibility setting head tip dresser: 5 manuals, 1 pneumatic.

SIGMA Pneumatic Changer Patent 1427232 for Fixed Welding Guns

Description

- 01 Machines
- 02 Pneumatic electrode changer for fixed welding guns
- 02 SIGMA Pneumatic motor
- xxxxx Sequential edited by the SINTERLEGHE Technical office for client's technical specifications

MECHANICAL INTERFACE

	<ul style="list-style-type: none"> • (LxW) 102 x 75 mm
Base Plate	<ul style="list-style-type: none"> • (fixing holes) 4 x Ø 9 mm holes • (Distance between holes) 40 x 40 mm
Head orientation	Head adjustable. The height, horizontal angle of the head can be set according to customer's need.

SIGMA PNEUMATIC CHANGER' FEATURES

Tip-dresser's head height	20 mm
Cutter rotation speed loadless	210 rpm

- +** **PLUS**
- Bidirectional releasing system patent 1427232
 - Electrodes magazine patent 1420033 containing up to 28 Ø 16mm electrodes or up to 20 Ø 20 mm electrodes
 - Compact overall dimensions

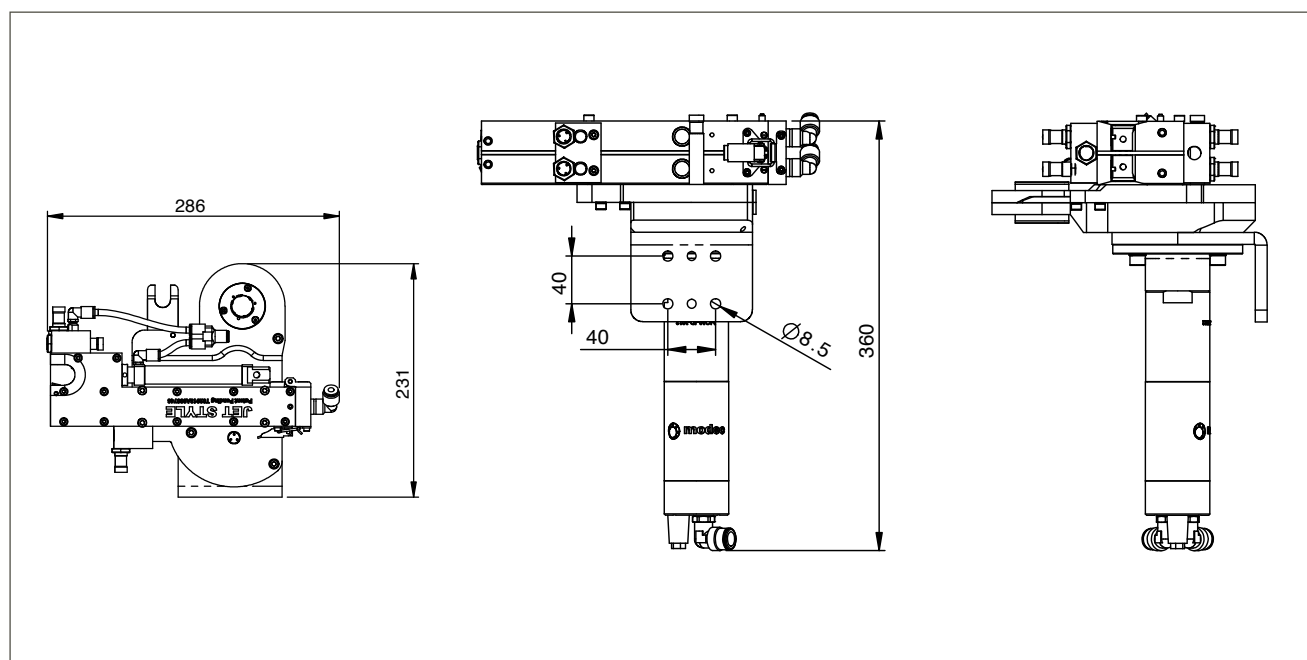

SIGMA Manual Dresser

Description

- 01 Machines
- 05 Manual tip dresser
- 01 Pneumatic operation
- XXXXX Sequential edited by the SINTERLEGHE Technical office for client's technical specifications

TIP DRESSER'S FEATURES

Distance cutter center - carter edge	39 mm
Tip-dresser's head height	20 mm
Cutter rotating direction	Clockwise

- + **PLUS**
- Possibility to mount three blades or single blade cutter
- AIR SUPPLY: 6 BAR ISO 8573 Class 3.4.3
- AIR PIPE SUPPLY:
- Ø 10 external
- Ø 8 internal minimum

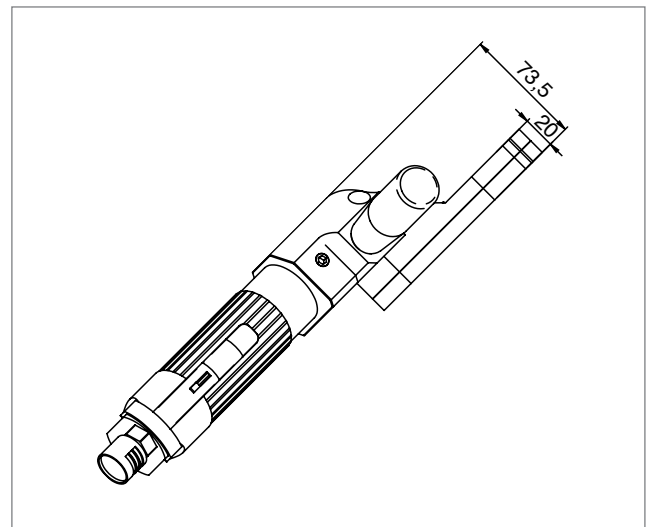
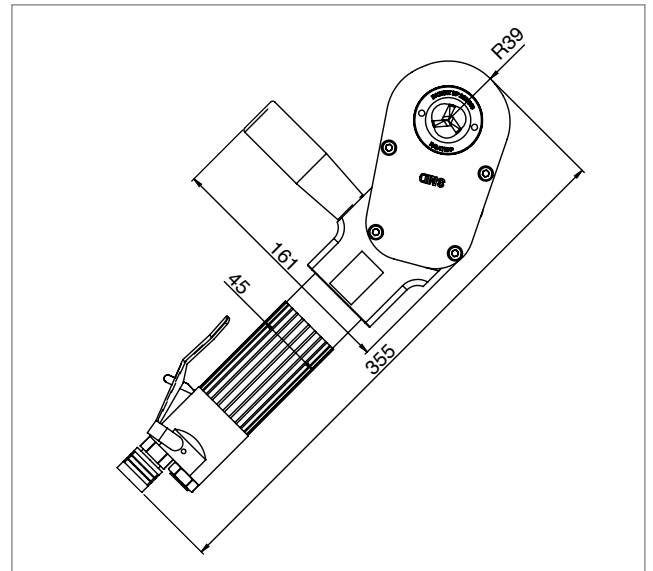

OMICRON Optical Sensor
Patent EP2938454

Intelligent sensor for detecting the geometry of the electrode and brightness of the welding lens.



FUNCTIONS

Optical detection and analysis of the level of contamination of the welding lens	<i>Accuracy of 5% in measurement of the contaminated area</i>
Optical detection and analysis of the electrode geometry in order to measure height and estimated deformation of the welding lens	<i>Accuracy of 0.1 mm on dimensional measurements</i>
Integrated logic to establish level of polishing and dressing required to restore maximum welding efficiency	<i>Cost reduction on electrode replacements</i>
Integrated adaptive logic to optimise the maximum number of welding spots performable before further monitoring operation	<i>Optimal trade-off between efficiency of use of the robot, energy consumption and welding quality</i>
Integration of HW/SW with welding cell in accordance with the paradigms of 4.0 industry	
Logging data with functions of simplified extraction of files for offline analysis	
Configuration software based on web technology	

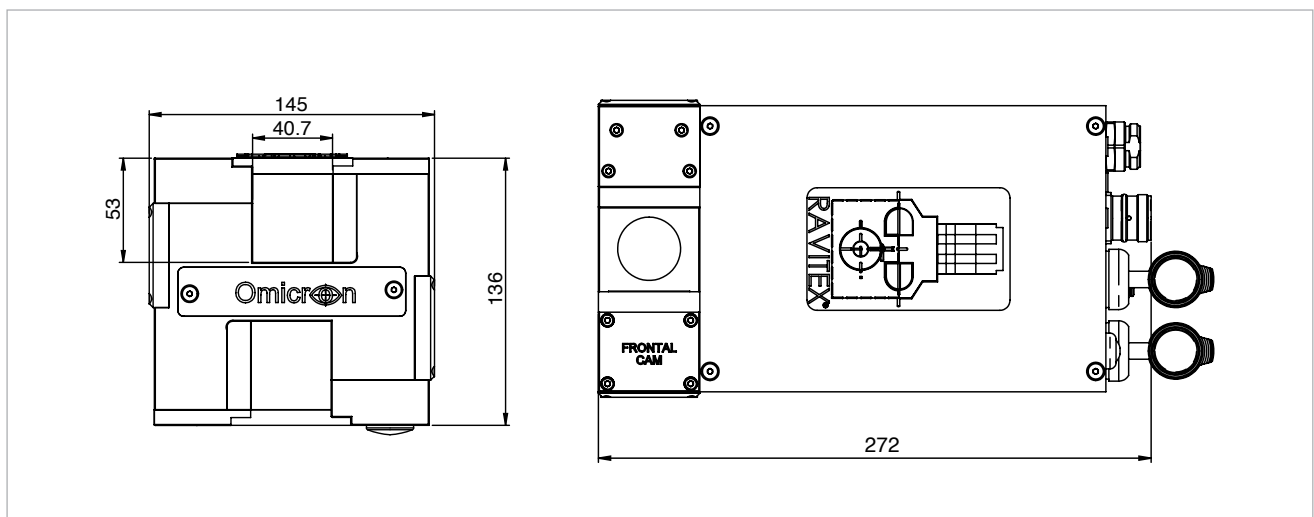

The **OMICRON** Optical Sensor Patent **EP2938454** will be available from February 2018.

RAVITEX® ACCESSORIES

Electrode Extractor Wrench in Steel

Order number
19PA-04380



Electrode Extractor Wrench in Chromed Steel with Hammer

Order number
19PA-01372



Calibration Tool for Welding gun/Cutter

Order number

070101000040

for upper electrode diam 16,00 mm

070101000041

for lower electrode diam 16,00 mm

070101000154

for upper electrode diam 20,00 mm

070101000155

for lower electrode diam 20,00 mm



RRM Manual Tip Dresser

Order number

163R-03633





Partner

SWEDEN

SVETSRADET AB
Soldatgatan 14
18534 Vaxholm Svezia

Mr. Stefan Borg

Tel +46 (0)8-6732330

Fax +46 (0)8-6732335

stefan.borg@svetsradet.se



Branch

GERMANY

SINTERLEGHE GmbH
Wieselacker 7A D-35041
Marburg a.d. Lahn

Mr. Umberto Adami

Tel +49 178 5670938

Fax +49 6421 360453

umberto.adami@sinterleghe.com



Head Office

ITALY

Registered office

Via Cenischia, 33
10139 Torino

Tel +39 011 33 14 24

Fax +39 011 38 54 774

accounting@sinterleghe.it

Manufacturing plant

Via alla Segna, 10
28877 Anzola d'Ossola (VB)

Tel +39 0323 83 78 62

Fax +39 0323 83 993

ravitec.engineering@sinterleghe.it



Branch

BRAZIL

SINTERLEGHE DO BRASIL S/A

Rua Fábio de Almeida Magalhães,
n° 207 Sala. 03 - Jardim St° Elias
São Paulo SP - CEP 05135-370

Mr. Pindaro R. Cacheiro

Tel + 55 11 39030969

Mob + 55 11 998684294

pindaro.cacheiro@sinterleghe.it

massimo.fornasari@sinterleghe.it



Partner

MEXICO

AUTOMATICS S.A. DE C.V.

Hidalgo #33 Col. El Colorado
El Marques 76246 Querétaro
City - Estate of Querétaro

Ing. Victor Morales Rebollo

Tel +5221 442 141414

victor.morales@automatics.com.mx

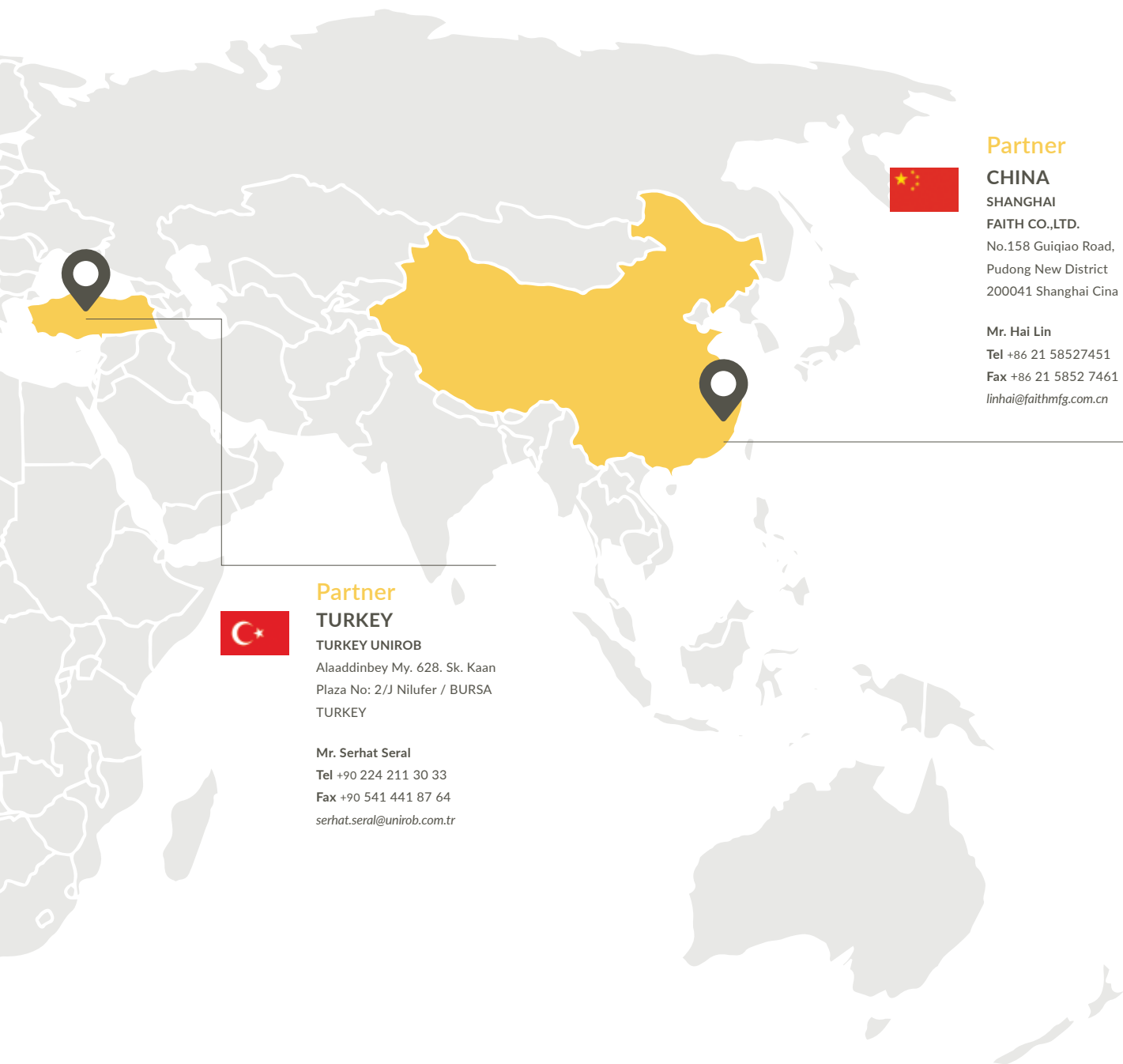

Partner

CHINA

SHANGHAI
FAITH CO.,LTD.
No.158 Guiqiao Road,
Pudong New District
200041 Shanghai Cina

Mr. Hai Lin
Tel +86 21 58527451
Fax +86 21 5852 7461
linhai@faithmfg.com.cn

Partner

TURKEY

TURKEY UNIROB
Alaaddinbey My. 628. Sk. Kaan
Plaza No: 2/J Nilufer / BURSA
TURKEY

Mr. Serhat Seral
Tel +90 224 211 30 33
Fax +90 541 441 87 64
serhat.seral@unirob.com.tr

To look for our partner in your Country, visit www.sinterleghe.it

If you want to become part of our sales network, send an e-mail to: ravitex.sales@sinterleghe.it



Since 1992 **SINTERLEGHE** has used the Ravitex® brand to promote its philosophy and identify its products, by certifying the brand originality and quality. The **Ravitex®** logo and trademark are registered and deposited and they can be exclusively used by **SINTERLEGHE S.R.L.**

ALL PRODUCTS ARE TRADEMARKED 

www.sinterleghe.it

SINTERLEGHE S.r.l.

Registered offices Tel +39 011 33 14 24
Via Cenischia, 33 Fax +39 011 38 54 774
10139 Torino accounting@sinterleghe.it

Manufacturing plant
Via alla Sega, 10
28877 Anzola d'Ossola (VB)

Tel +39 0323 83 78 62
Fax +39 0323 83 993
ravitex.engineering@sinterleghe.it